

MATHEWS COUNTY

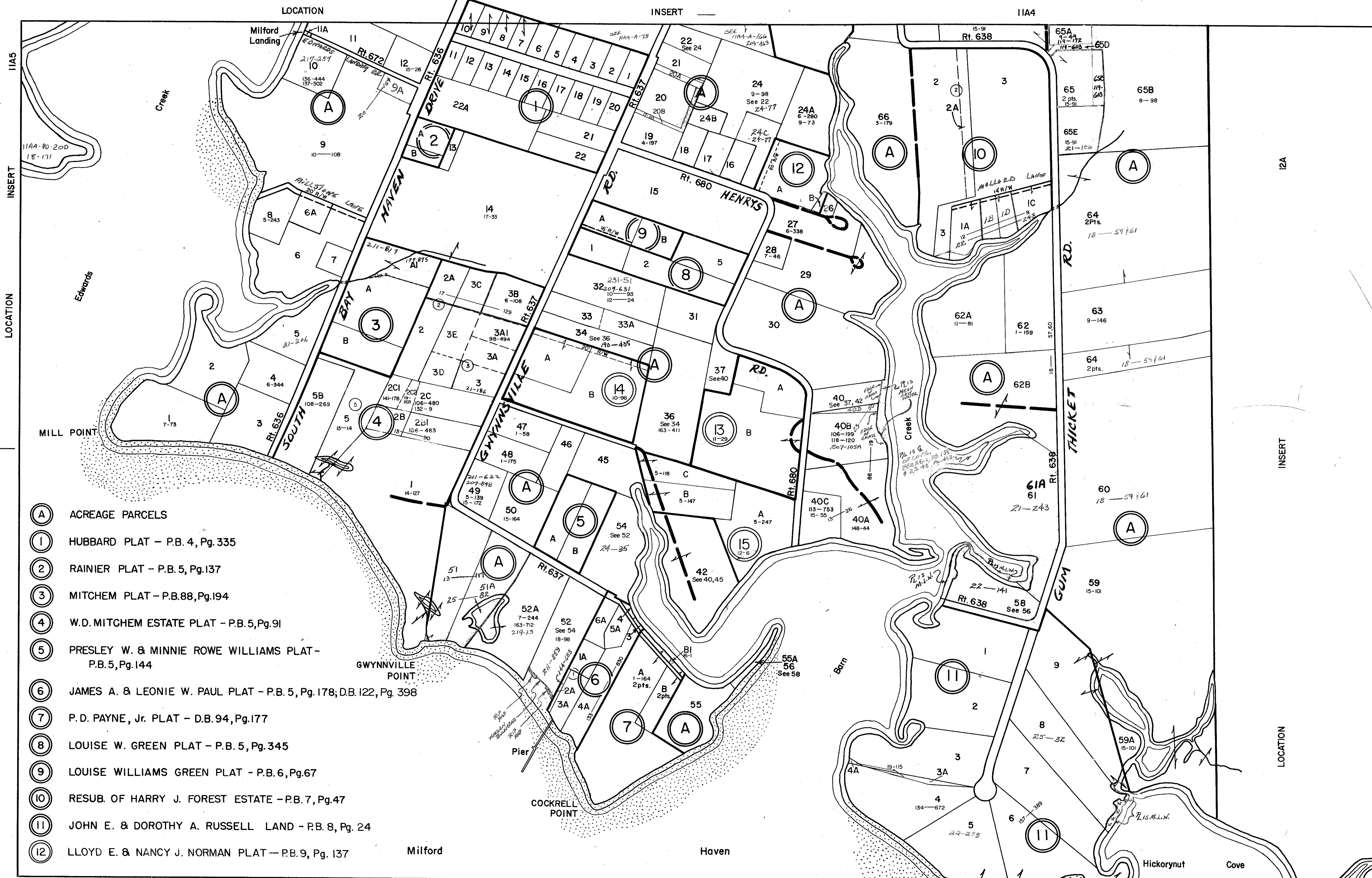

- (A) ACREAGE PARCELS
- (1) HUBBARD PLAT - P.B. 4, Pg. 335
- (2) RAINIER PLAT - P.B. 5, Pg. 137
- (3) MITCHEM PLAT - P.B. 88, Pg. 194
- (4) W.D. MITCHEM ESTATE PLAT - P.B. 5, Pg. 91
- (5) PRESLEY W. & MINNIE ROWE WILLIAMS PLAT - P.B. 5, Pg. 144
- (6) JAMES A. & LEONIE W. PAUL PLAT - P.B. 5, Pg. 178; D.B. 122, Pg. 398
- (7) P. D. PAYNE, Jr. PLAT - D.B. 94, Pg. 177
- (8) LOUISE W. GREEN PLAT - P.B. 5, Pg. 345
- (9) LOUISE WILLIAMS GREEN PLAT - P.B. 6, Pg. 67
- (10) RESUB. OF HARRY J. FOREST ESTATE - P.B. 7, Pg. 47
- (11) JOHN E. & DOROTHY A. RUSSELL LAND - P.B. 8, Pg. 24
- (12) LLOYD E. & NANCY J. NORMAN PLAT - P.B. 9, Pg. 137

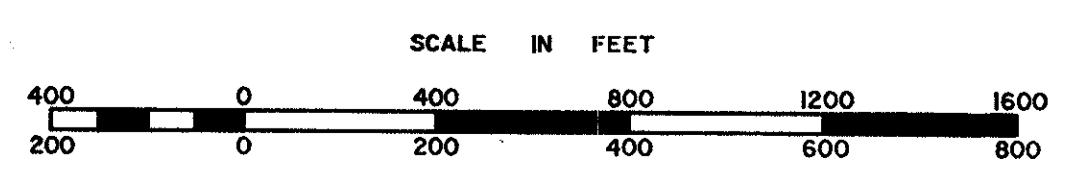

REVISED: 5-19-82 by Wingate Appraisal & Mapping Service, Roanoke, Virginia 1/1/87, 1/1/90, 10/92

PIANKATANK DISTRICT
GWYNN ISLAND

SECTION IIA6
INSERT IIA6

PREPARED BY VIRGINIA STATE DEPARTMENT OF TAXATION, DIVISION OF REAL ESTATE APPRAISAL AND MAPPING