

# MATHEWS COUNTY

LOCATION INSERT IIA3

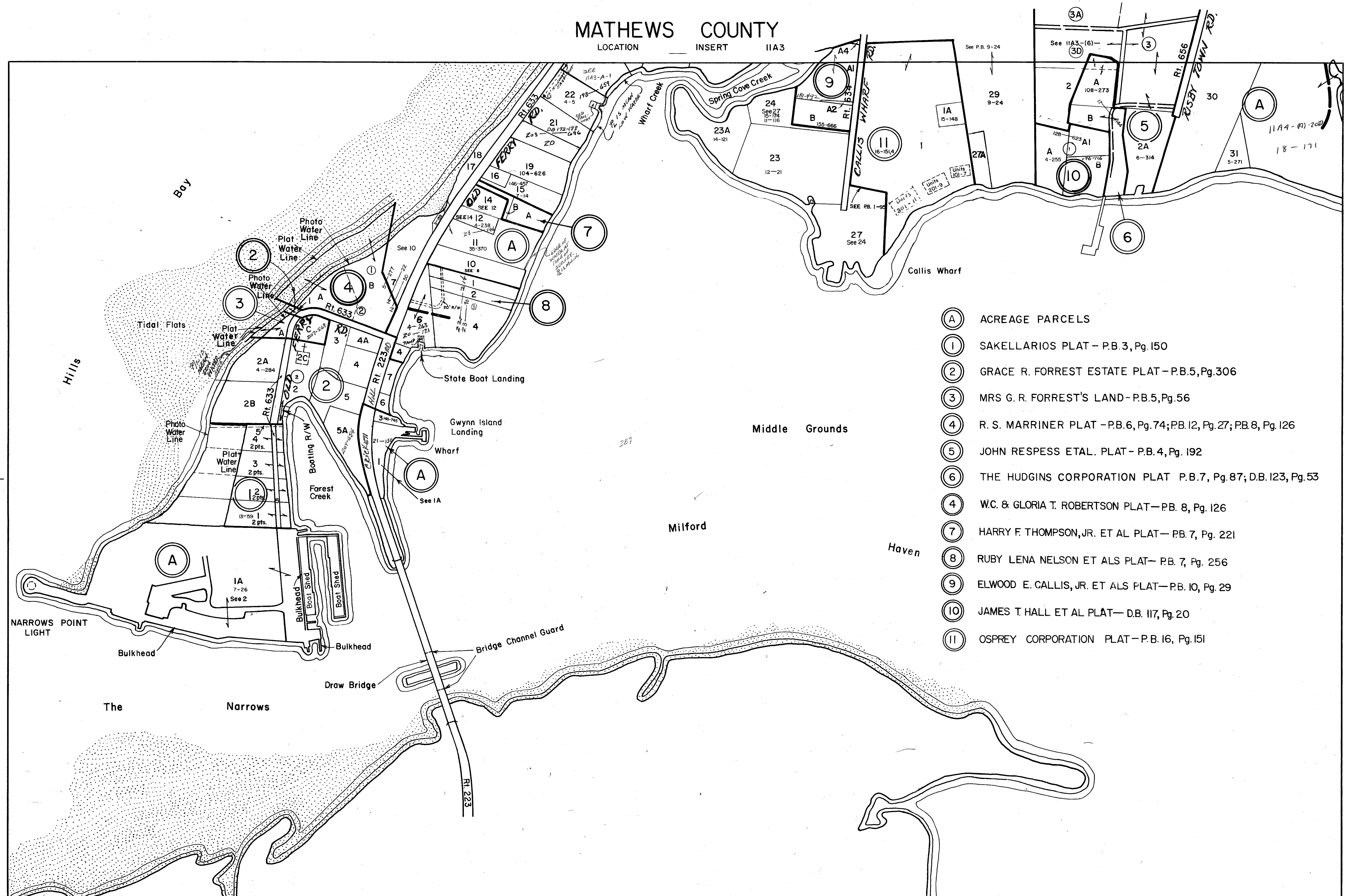

- (A) ACREAGE PARCELS
- (1) SAKELLARIOS PLAT - P.B. 3, Pg. 150
- (2) GRACE R. FORREST ESTATE PLAT - P.B. 5, Pg. 306
- (3) MRS G. R. FORREST'S LAND - P.B. 5, Pg. 56
- (4) R. S. MARRINER PLAT - P.B. 6, Pg. 74; P.B. 12, Pg. 27; P.B. 8, Pg. 126
- (5) JOHN RESPESS ET AL. PLAT - P.B. 4, Pg. 192
- (6) THE HUDGINS CORPORATION PLAT - P.B. 7, Pg. 87; D.B. 123, Pg. 53
- (7) HARRY F. THOMPSON, JR. ET AL PLAT - P.B. 7, Pg. 221
- (8) RUBY LENA NELSON ET ALS PLAT - P.B. 7, Pg. 256
- (9) ELWOOD E. CALLIS, JR. ET ALS PLAT - P.B. 10, Pg. 29
- (10) JAMES T. HALL ET AL PLAT - D.B. 117, Pg. 20
- (11) OSPREY CORPORATION PLAT - P.B. 16, Pg. 151

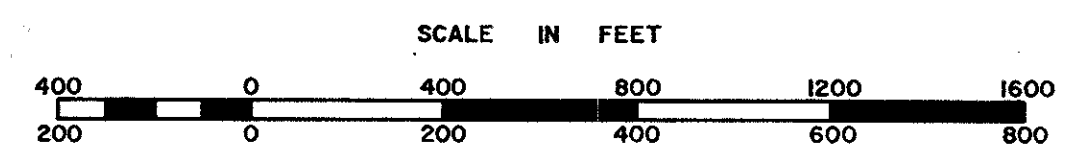

REVISED: 5-19-82 by Wingate Appraisal & Mapping Service, Roanoke, Virginia 1/1/87, 11/1/90, 10/92

PIANKATANK DISTRICT  
GWYNN ISLAND

SECTION  
INSERT IIA5

PREPARED BY VIRGINIA STATE DEPARTMENT OF TAXATION, DIVISION OF REAL ESTATE APPRAISAL AND MAPPING