

MATHEWS COUNTY

- (A) ACREAGE PARCELS
- (1) KENNY E. & FRANCES S. TAYLOR PLAT - P.B. 5, Pg. 37
- (2) W.M. MINTER ETAL TRUSTEE - P.B. 1, Pg. 168
- (3) J. RAYMOND CALLIS ESTATE - P.B. 5, Pg. 35
- (4) JAMES M. JARVIS ET UX PLAT - P.B. 4, Pg. 321
- (5) JEAN SKYLES HUDGINS & ROBERT B. HUDGINS PLAT - P.B. 1, Pg. 186
- (6) JOHN RESPASS ETAL PLAT - P.B. 4, Pg. 192
- (7) EUGENE B. & MARGARET S. CALLIS PLAT - P.B. 3, Pg. 203
- (8) GWYNN'S ISLAND CIVIC & CEMETERY LEAGUE PLAT - P.B. 5, Pg. 237
- (9) BENSTEN PLAT - P.B. 1, Pg. 38
- (10) LYNNHAVEN COURT, INC. - P.B. 6, Pg. 120
- (11) MILLER PLAT
- (12) LEE & SKYLES PLAT - P.B. 11, Pg. 130

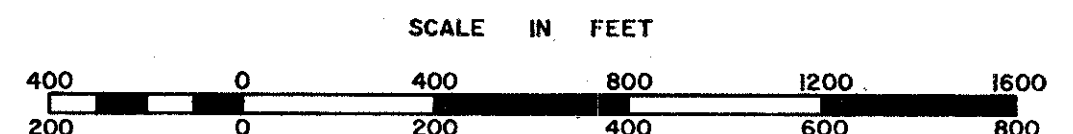
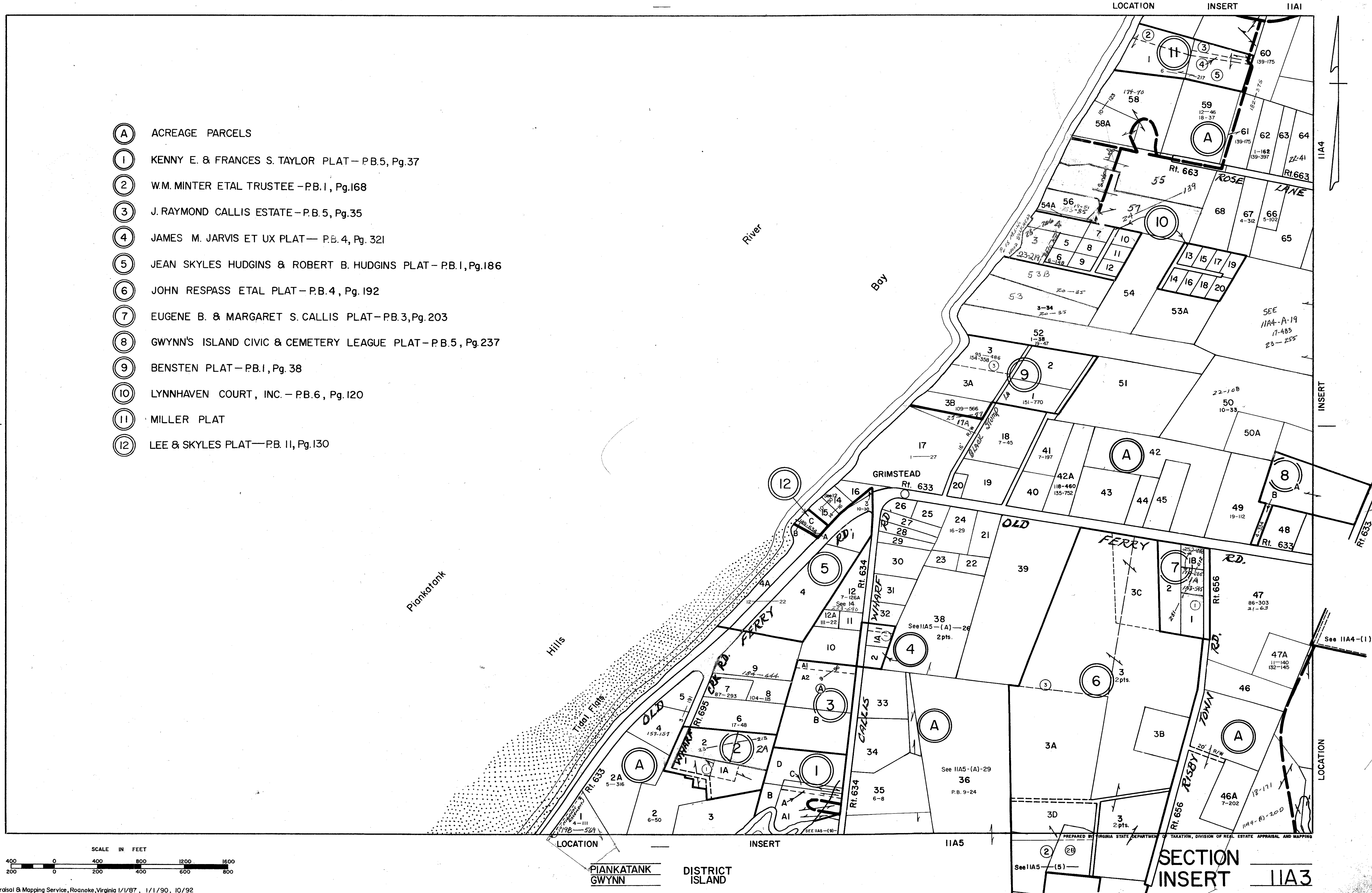

PIANKATANK DISTRICT
GWYNN ISLAND

SECTION IIA3
INSERT IIA3

PREPARED BY VIRGINIA STATE DEPARTMENT OF TAXATION, DIVISION OF REAL ESTATE APPRAISAL AND MAPPING