

MATHEWS COUNTY

- (A) ACREAGE PARCELS
- (1) GWYNNS ISLAND ESTATES—SECTION C—PB.4, Pg.289
- (2) GWYNNS ISLAND ESTATES—SECTION B—PB.1, Pg.209
- (3) GWYNNS ISLAND ESTATES—SECTION 2—PB.4, Pg.164A
- (4) CHERRY POINT EST.—PB.1, Pg.210
- (5) REV. LOTS 1 & 2 OF CHERRY POINT ESTATES—D.B.88, Pg.615
- (6) GWYNNS ISLAND EST.—SEC.1—PB.4, Pg.156A
- (7) KING—PAYNE PLAT—UNRECORDED
- (8) EDWIN R. CARTER PLAT—PB.1, Pg.112
- (9) BASS ENTERPRISES—D.B.94, Pg.113; P.B.3, Pg.240; P.B.14, Pg.140
- (10) ELDRIDGE W. RAINIER LAND—D.B.92, Pg.280
- (11) HODGES PLAT—PB.6, Pg.235
- (12) HERBERT H. UPDIKE, JR. & MARGARET W. UPDIKE PLAT—PB.5, Pg.134
- (13) ELMER F. GALLIMORE & LULA D. GALLIMORE PLAT—PB.5, Pg.213
- (14) STUART E. & MIRIAM L. NICHOLS—PB.7, Pg.4
- (15) STUART E. & MIRIAM NICHOLS PLAT—PB.5, Pg.214
- (16) JAMES LYNN JUDSON ET AL'S PLAT—P.B.12, Pg.39
- (17) HOPESVILLE CHRISTIAN ACADEMY PLAT—P.B.15, Pg.142

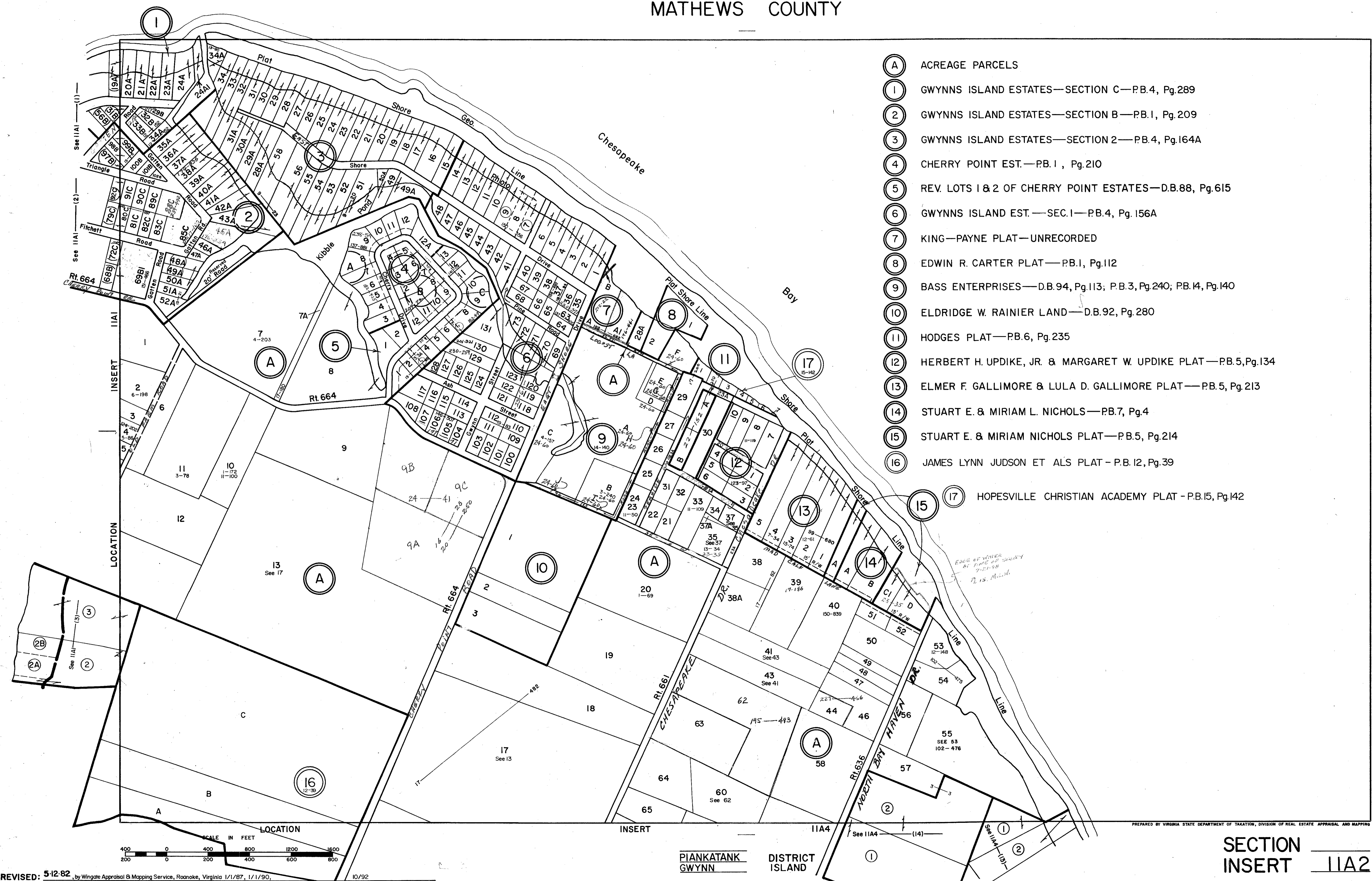

REVISED: 5-12-82, by Wingate Appraisal & Mapping Service, Roanoke, Virginia 1/1/87, 1/1/90, 10/92

PREPARED BY VIRGINIA STATE DEPARTMENT OF TAXATION, DIVISION OF REAL ESTATE APPRAISAL AND MAPPING

SECTION
INSERT IIA2