

MATHEWS COUNTY

40

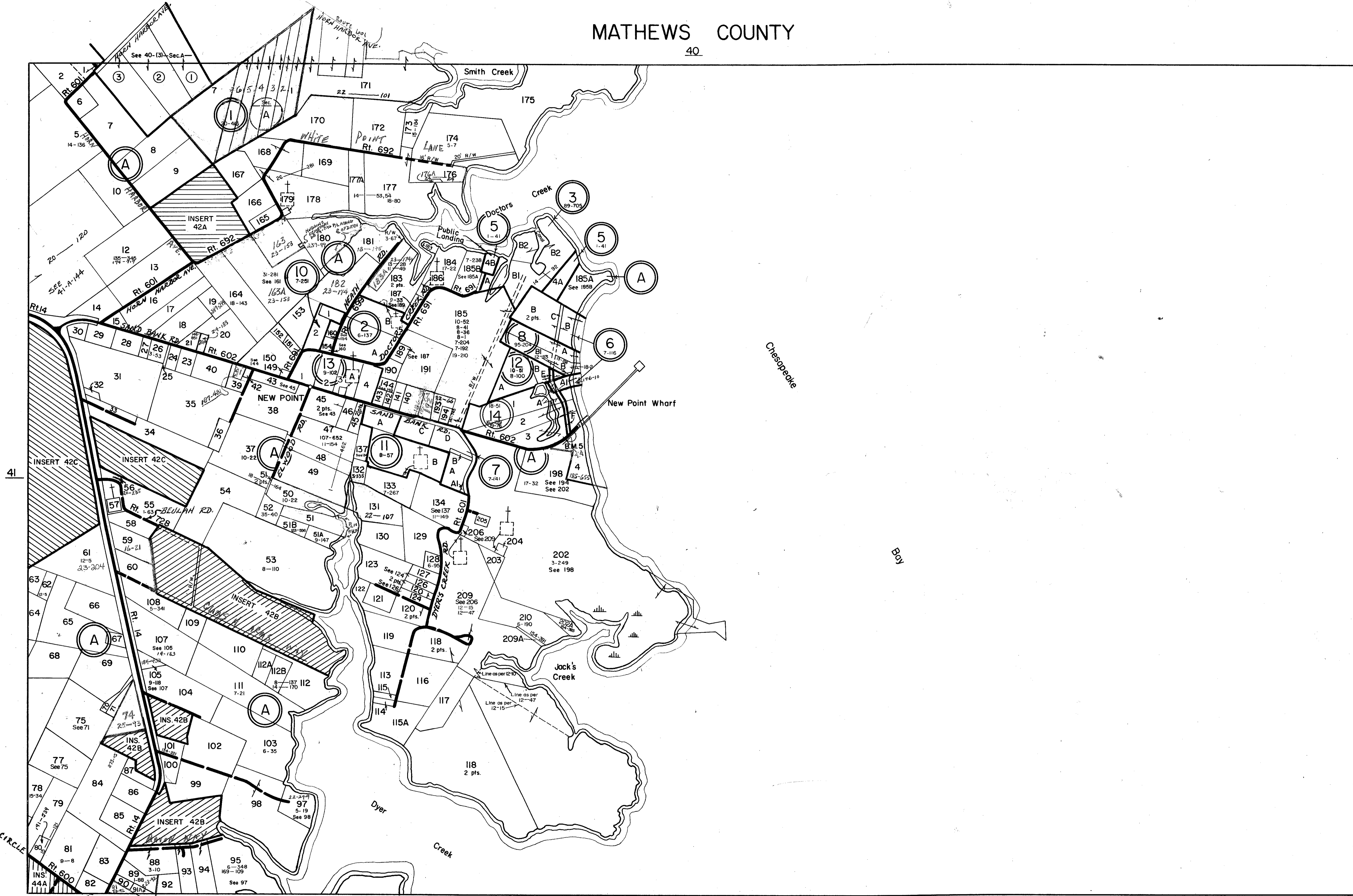

NONE

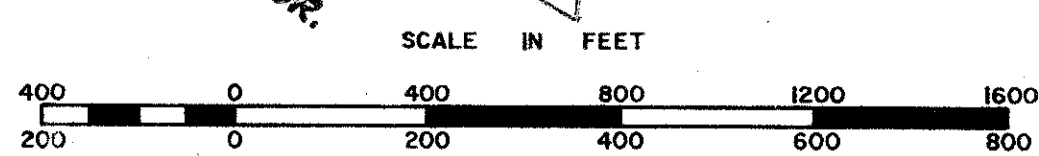

44

PREPARED BY VIRGINIA STATE DEPARTMENT OF TAXATION, DIVISION OF REAL ESTATE APPRAISAL AND MAPPING

CHESAPEAKE DISTRICT

SECTION 42
INSERT

REVISED: 7-6-82, by Wingate Appraisal & Mapping Service, Roanoke, Virginia 1/1/87, 1/1/90, 10/92