

MATHEWS COUNTY

34

WASHINGTON ST. Rt. 660 INS. 34B WATER ST.

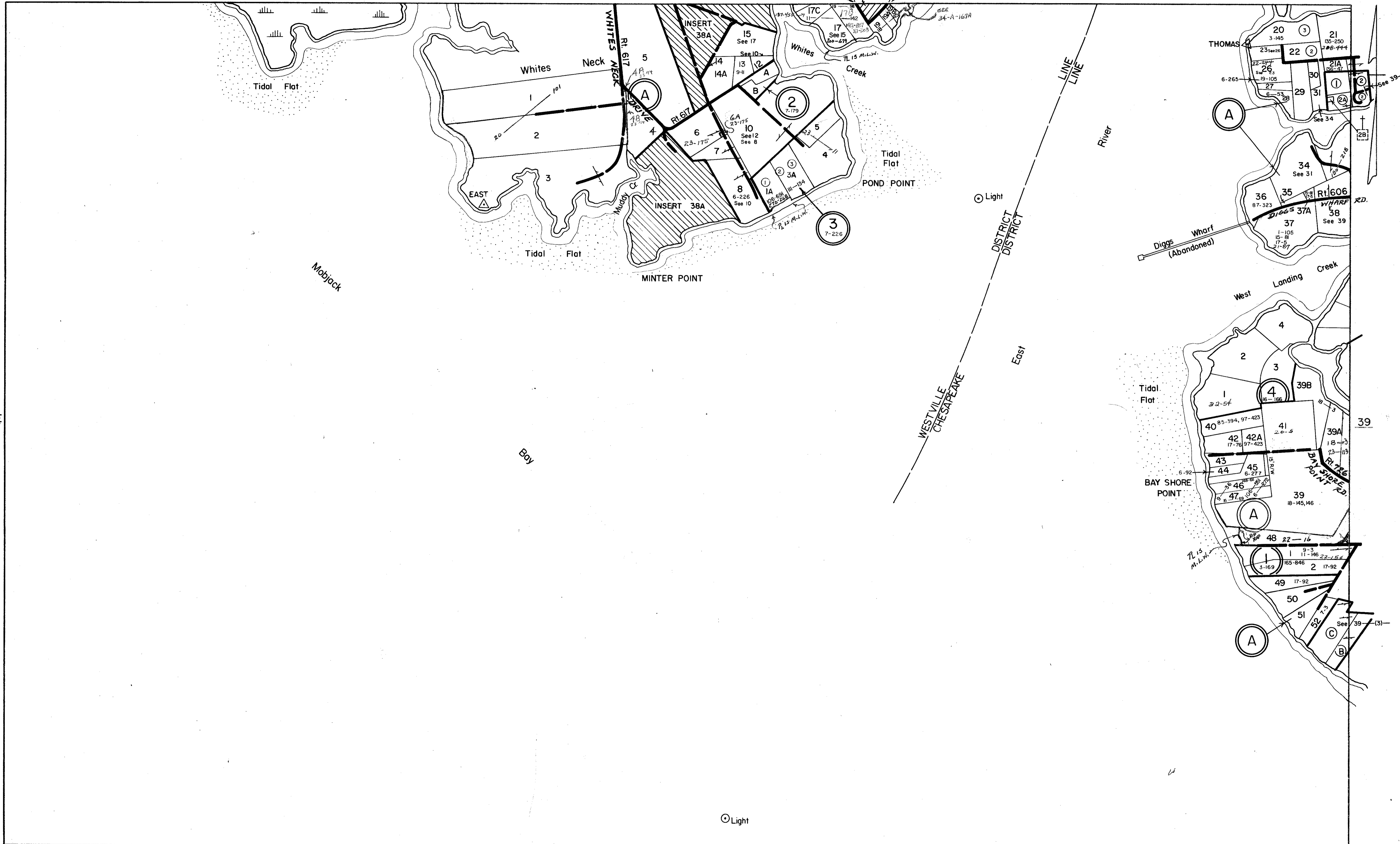

NONE

NONE

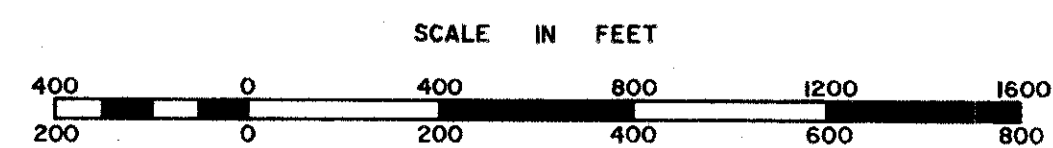

WESTVILLE CHESAPEAKE DISTRICT

SECTION 38 INSERT

PREPARED BY VIRGINIA STATE DEPARTMENT OF TAXATION, DIVISION OF REAL ESTATE APPRAISAL AND MAPPING